

innex C830

Panoramic Conference Camera

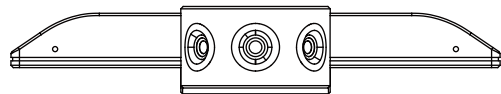

Quick Start Guide

Package Contents



Device



USB Cable



Safety, Compliance
and Warranty



Quick Start Guide



Wall Bracket



Rubber expansion plug X2



Self-tapping Screw X2
(KA4X30mm)



Thumb Screw
(1/4-20-L8mm)

Wall Mount kit

Camera Overview

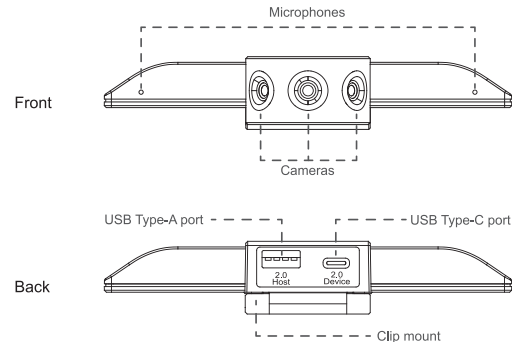

(1) USB Type-C port: For connecting the Type-C end of the bundled USB cable which should then be connected to a USB A port of a laptop or workstation. This connection will provide power to the camera and transmit both video and audio from the camera to the computer.

(2) USB Type-A port: For connecting to a type A USB cable which connects to another USB device such as an external Bluetooth conference speaker.

Top

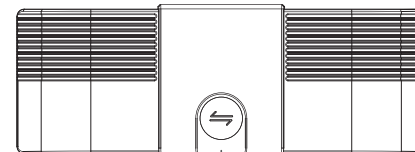

Touch Button

(1) The touch button can change the camera horizontal view angle in a sequence of 180°, 150°, 120°, 90°, and 75°.

(2) Gently touch the button once to trigger view angle changes, an OSD with the corresponding view angle will also appear on the camera image.

(3) While in a certain view angle, press and hold the touch button to trigger panning. When reaching the desire FoV within the scene, simply release the touch button to keep the desired FoV.

Setup and Installation

Connecting Camera

- (1) Connect the Type C end of the bundled USB cable to the Type-C port at the back of the Camera.
- (2) Connect the Type-A end of the same cable to a laptop or workstation.

Mounting Camera

Clip Mount:

Easily mount onto any display such as laptop, monitor, television, or interactive display using the built-in clip mount.

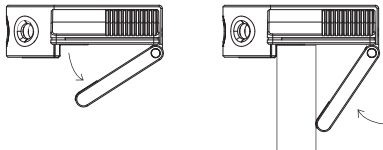

Tripod Mount:

Tripod screw holes are located at the bottom of the clip mount for tripod mounting.

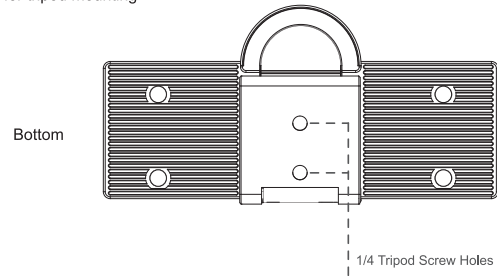

Wall Mount:

- (1) Drill two 6mm diameter holes that are 28mm apart horizontally on a wall. Take two rubber expansion plugs and push them into the holes.

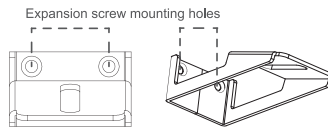

- (2) Screw drives the wall bracket tightly against the wall with the two self-tapping screws.

- (3) Position the camera's tripod 1/4" hole onto wall bracket's opening and twist the thumb screw into it, continue until the camera is tightly mounted onto the wall bracket.

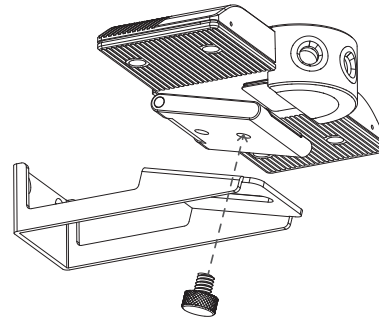

Innex Studio

To unlock all features of C830, please download our camera software: Innex Studio.

Visit our website funtechinnovation.com and

- (1) click on Software
- (2) click on Innex studio to know more.

EC

REP

APEX CE SPECIALISTS LIMITED

UNIT 3D NORTH POINT HOUSE,
NORTH POINT BUSINESS PARK, NEW MALLOW
ROAD, CORK, T23 AT2P, IRELAND

UK

REP

APEX CE SPECIALISTS LIMITED

89 Princess Street, Manchester, M1 4HT, UK

FR



Vous êtes responsable de remettre tous les appareils électriques et électroniques usagés à des points de collecte correspondants.

Pour en savoir plus:
www.quefairemesdechets.fr